

### PRODUCT DATA SHEET

#### ■ Introduction

ENVIRCO's cleanroom ceiling solution, a 2" Gasket Seal Grid Cleanroom Ceiling System is fabricated using superior materials to provide both a structural grid system and zinc alloy die-castings.

The building block of a cleanroom ceiling grid system is the connection and suspension system. ENVIRCO offers a true, extruded aluminum 2" cleanroom ceiling system. It is the most cost efficient system for cleanroom classes for ISO 8 (Class 100,000) to ISO 5 (Class 100), or any full HEPA coverage application.

ENVIRCO's rod suspended cleanroom ceiling systems share attributes that in combination create a common design platform. Customizing this system to meet your specific needs is easy and worry-free. Call one of our engineers today to discuss options and find the system that best meets your needs.

#### ■ Standard Features

ENVIRCO's gasket seal grid ceiling system has a continuous 1/4-20 thread for connection and suspension at any point. It also has lightweight multi-purpose connectors that join the grid members, providing a suspension point for the threaded rods or wire-hung eye bolts.

- » 2" wide extruded aluminum flange for HEPA filter, ceiling tile, and light fixture mounting.
- » 3/8" thread rod and turnbuckle adjustable or 3/8" eye bolt and 12 ga. ceiling wire.
- » Full 2" face.
- » Painted white polyester finish, more durable than powder coating.
- » Gasketed (closed cell white).
- » Can be used with 100% HEPA coverage.
- » Can be used with cleanroom lights made for 2" grid or teardrop light fixtures.
- » Easy assembly.
- » Zinc alloy castings.
- » Center Line of Grid - 24 1/2" x 48 1/2"
- » Module, Fixture, and Ceiling Tile Size - 23 5/8" x 47 5/8"

#### ■ Optional Feature

- » Clear anodized aluminum finish.

#### ■ Warranty

- » Limited 1-year warranty.

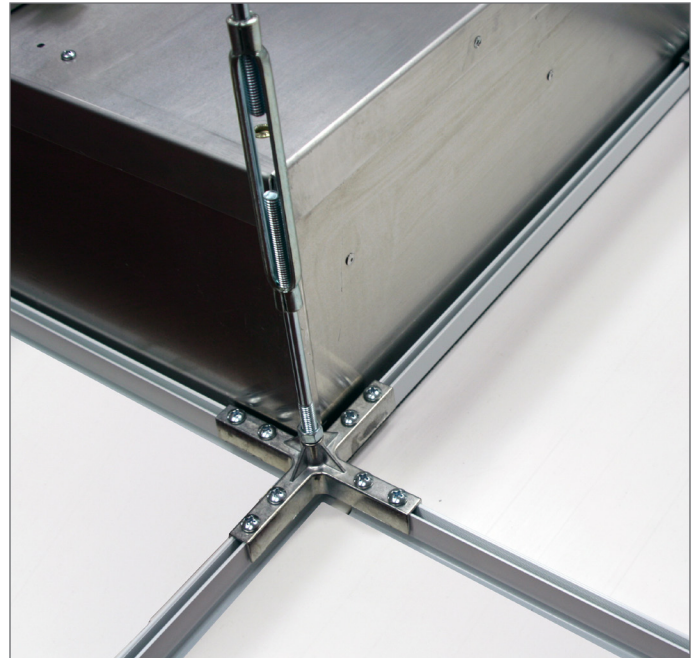

#### ■ ENVIRCO T-Grid Load Table

Deflection Formula	L/360	L/180	L/360
Hanger Spacing (Span)	48"	48"	24"
Main Tee Spacing	48"	48"	48"
Maximum Point Load (Lbs)	133	133	238
Maximum Uniform Load (Lbs/LF)	96	96	48
Applied Load (Lbs/SF) (Dead+Live with Filter)	24	24	24
Deflection at Mid-Span	1/8"	1/4"	1/16"

# MAC-T Ceiling System

## 2" Heavy Duty for Cleanroom

### PRODUCT DATA SHEET

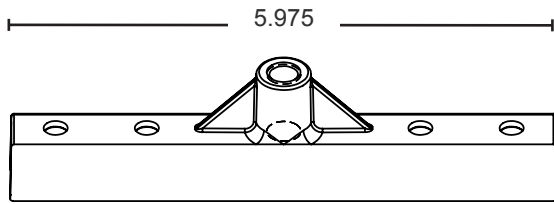

2 Way Connection

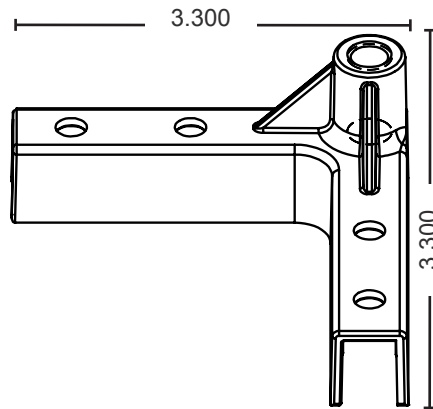

2 Way Corner

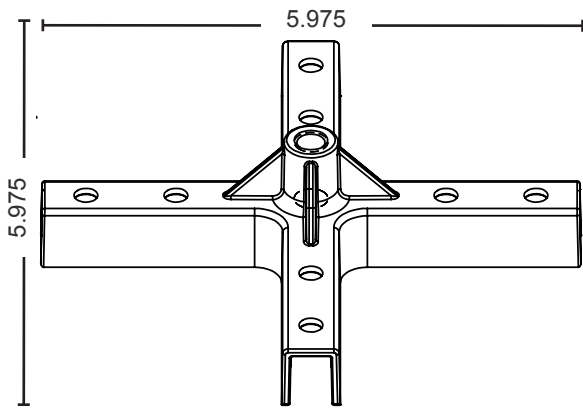

4 Way Cast

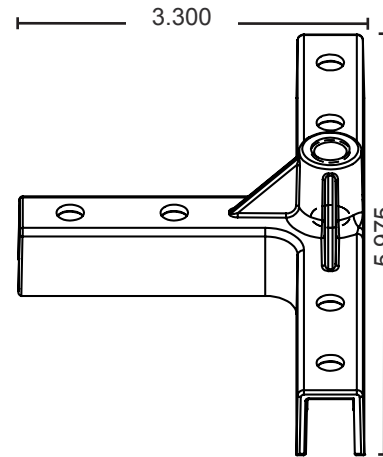

3 Way Cast

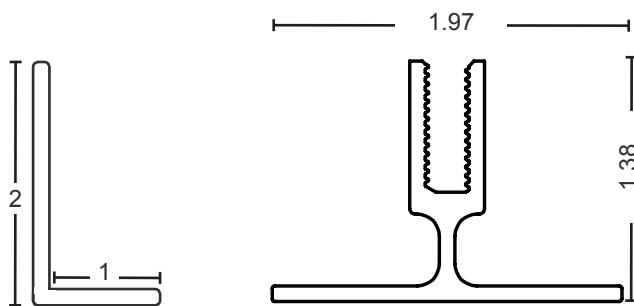

Wall Mount

Main Runner

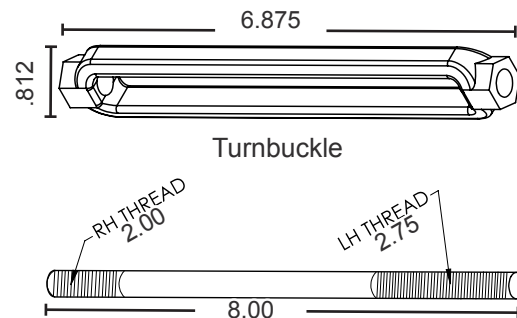

Turnbuckle

Threaded Stud